

Whilst every care has been taken to ensure the accuracy of this leaflet, Cheshire West and Chester Council cannot accept responsibility in respect of any error or omission which may have occurred.

www.itravelmart.co.uk
www.facebook.com/itravelmart
@itravelmartuk

0845 838 0651 Sustrans
0300 123 7024 Park & Ride
0845 748 950 National Rail
01606 288 539 Cheshire West and Chester
Public Rights of Way,
Cheshire West & Chester Council
0300 123 8123
01244 312 626 Chester Shopmobility
0871 200 22 33 Traveline North West
0845 647 7868 Chester Visitor Information Centre

Useful Contacts

INTRODUCTION

These maps have been made for you to be able to get around your local area more easily, and find healthier, quicker, cheaper and greener ways to travel.

ON FOOT



Walking keeps you **fit and healthy**, and you'll arrive at your destination feeling fresh and alert.

Why not take a stroll around the **nearby lake** or, for the more adventurous, try a walk through the **woodland**. Suggested walking routes and footpaths have been marked overleaf.

BY BIKE



Cycling could make your journey **quicker, cheaper, healthier and more enjoyable**. As a Cycling Demonstration Town, Chester benefits from a **range of cycle routes, both on and off road**.

The cycling distance from Chester Railway Station to the Business Park is about 3.5 miles and takes an average of **25 minutes** via the Groves and Handbridge. Nearby Lache and Handbridge both have **cycle friendly roads and paths**.

For more information on local cycle routes visit www.cheshirewestandchester.gov.uk/transport.

BY BUS



Chester Business Park is served by bus services 1, X44, X55 and DB8. Bus stops are on the map overleaf.

From Chester Railway station take services 1, X44, or X55. The journey takes **16 minutes and buses depart every 12 minutes**.

From Wrexham, Service 1 runs directly to and from Chester Business Park **up to five times an hour** and takes about 30 minutes. The **Sapphire** bus service has **free wifi** and **plugs to charge your devices**. To plan your journey visit www.traveline.info.

For those who prefer printed information, you can download, print or order timetables and public transport maps at www.cheshirewestandchester.gov.uk/transport.

CAR SHARING



If you commute to Chester Business Park and want to find a lift, or have a spare seat in your car, you can join the **Chester Business Park car share database** <https://cbp.carshare.uk.com/>, or sign up at www.liftshare.com.

City Car Club – Car clubs give you 24/7 access to a car without owning one. For more information, visit www.citycarclub.co.uk.



Walking times are based on average adult walking pace on a flat grade.
Base map data © OpenStreetMap contributors, CC-BY-SA.
Contains data © Crown copyright and database rights 2014.
Ordnance Survey 1000491046
Cartography by Steer Davies Gleaves 2014.







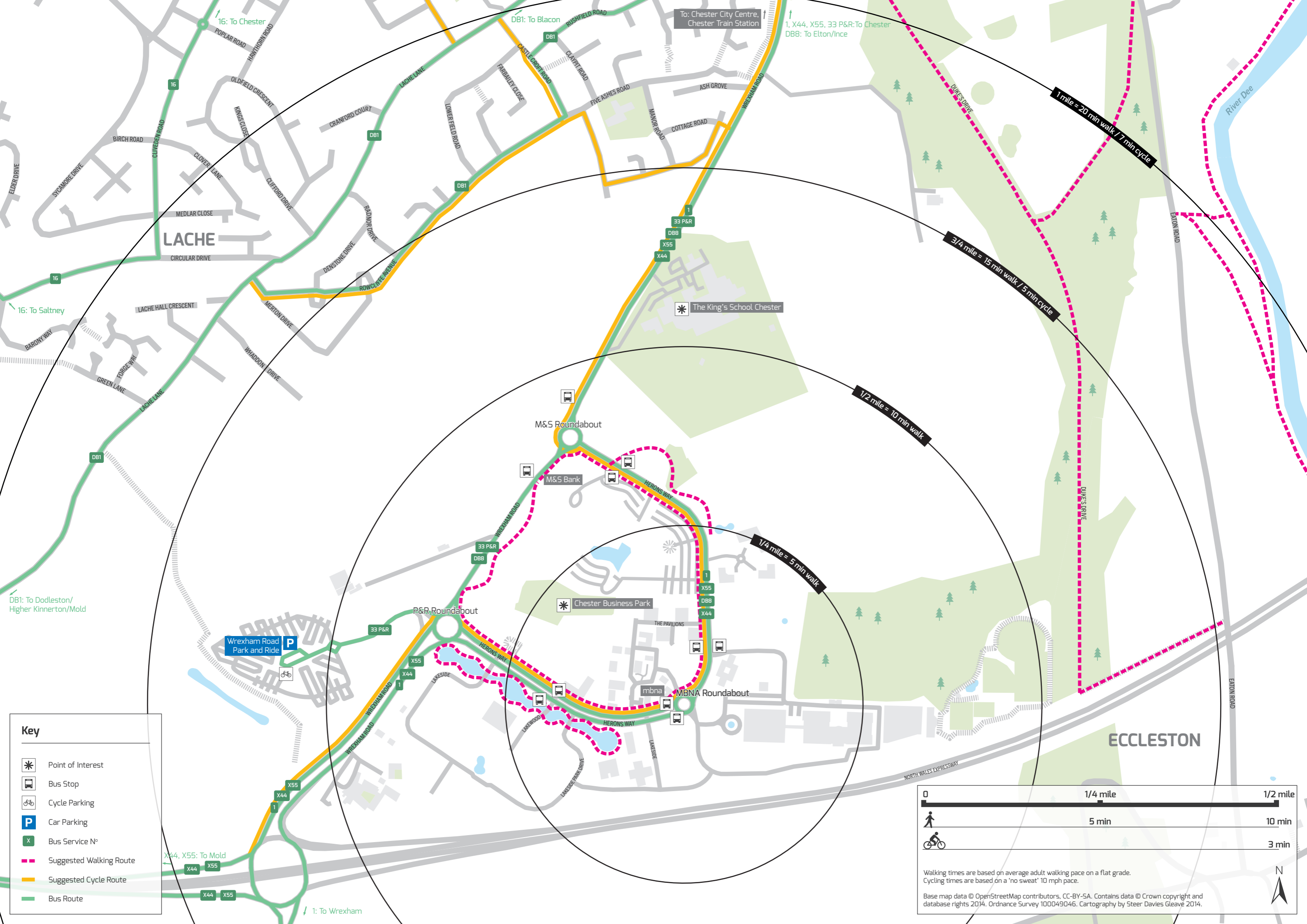



Chester Business Park
Active Travel Map





Key

-  Point of Interest
-  Bus Stop
-  Cycle Parking
-  Car Parking
-  Bus Service N°
-  Suggested Walking Route
-  Suggested Cycle Route
-  Bus Route

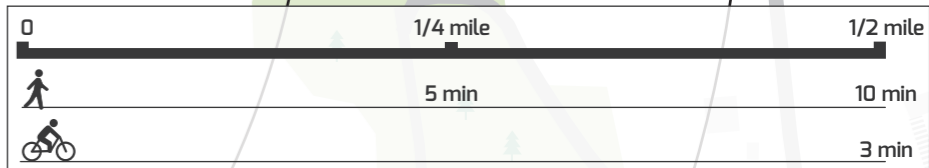

Walking times are based on average adult walking pace on a flat grade.
 Cycling times are based on a 'no sweat' 10 mph pace.

Base map data © OpenStreetMap contributors, CC-BY-SA. Contains data © Crown copyright and database rights 2014. Ordnance Survey 100049046. Cartography by Steer Davies Gleave 2014.

